





SKU: BV5063

-  Mini Ball Valve M x F, Winged Lever Operator
-  Mini -Kugelhahn M x F, Winged Lever Operator
-  Mini Válvula de bola M x F , con alas de palanca del operador
-  Mini Ball Valve M x F, Winged levier opérateur

**Valves**<sup>™</sup>  
O N L I N E

- 1/4 " – 1/2" Mini brass sandblasted nickel plated ball valve
- 1/4 " – 1/2" Mini Messing sandgestrahlt vernickelt Kugelhahn
- 1/4 " – 1/2" Mini latón níquel satinado válvula de bola plateada
- 1/4 " – 1/2" Mini laiton nickelé sablé vanne à boisseau sphérique plaqué

### Brass Ball Valve Winged Lever M x F BSPP



- Sandblasted and Nickel Plated
- Winged Lever
- Screwed BSPP
- -10°C to 90°C
- PN16 Rated

#### DESCRIPTION

Nickel plated M x F, mini ball valve with winged lever operator, for use on pneumatic and liquid applications. Valve offers reliable on / off operation.



#### Description

Sandblasted and nickel plated mini ball valve with winged operator, reduced bore screwed BSPP Male x female. 1/4" – 1/2" PN16, Temperature Range -10° C to 90° C. Typically used in pneumatic systems, HVAC and small industrial isolation use.



#### Beschreibung

Sandgestrahlt und vernickelt Mini-Kugelhahn mit Flügelbetreiber, reduzierter Durchgang geschraubt BSPP Männlich x weiblich. 1/4 " - 1/2" PN16, Temperaturbereich -10 ° C bis 90 ° C Typischerweise in Druckluftanlagen , Klimatechnik und kleine IndustrieisolationGebrauch verwendet .



#### Description

Arenado y niquelado de mini válvula de bola con el operador alado , paso reducido atornillado BSPP macho x hembra . 1/4 " - 1/2" PN16 , Rango de temperatura de -10 ° C a 90 ° C.





Normalmente se utiliza en sistemas neumáticos , HVAC y los pequeños el uso de aislamiento industrial.



#### Descripción

Sablé et nickelé mini- vanne à boisseau sphérique avec opérateur ailé, passage réduit vissé BSPP Homme x femelle. 1/4 " - 1/2" PN16 , plage de température -10 ° C à 90 ° C.

Généralement utilisé dans les systèmes pneumatiques , CVC et petite utilisation d'isolation industrielle .

-  Mini Ball Valve M x F, Winged Lever Operator
-  Mini -Kugelhahn M x F, Winged Lever Operator
-  Mini Válvula de bola M x F , con alas de palanca del operador
-  Mini Ball Valve M x F, Winged lever opérateur

## 2/2 Mini brass ball valve with winged lever

An aesthetically pleasing nickel plated, polished mini ball valve. Reduced bore screwed BSP Male x female. Operated via a winged lever with 90° turn.

Typical Applications: Isolation on Pneumatic system in small areas where a lever valve will not fit.

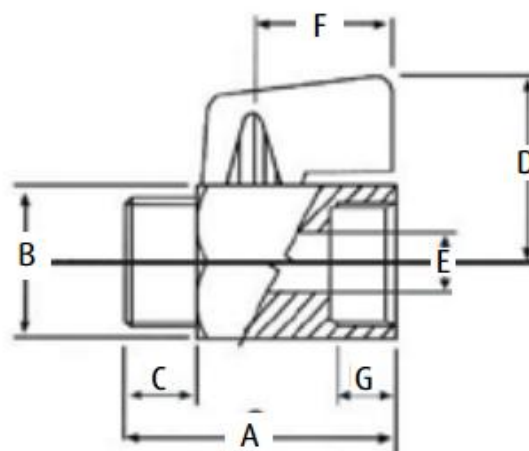

Dimensions shown are for guidance only

Dimensions							
DN	G	C	A	E	D	F	Kg
1/4"	9	10	39	6	29	19	0.09
3/8"	10	10	43	6	29	19	0.09
1/2"	10.5	12	47	10	29.5	23	0.12

Material List	
Body	Sandblasted, Nickel plated brass
Sleeve	Brass
Ball	Brass nickel plated
Seat	PTFE
Stem O-ring	NBR
Handle	Glass Fibre Reinforced Nylon

Pressure / Temperature Ratings	
Working Pressure	PN16
Temperature	-10°C to 90°C