





SKU: BV5052

-  Brass Ball Valve with Locking Lever Handle - BSPT
-  Messingkugelventil mit Feststellhebelgriff- BSPTAprobado Latón
-  Válvula de bola de latón con Bloqueo de manija de palanca - Laiton
-  Ball Valve avec la poignée de blocage de levier - BSPT

Valves[™]
O N L I N E

- 1/4 " - 4" Brass nickel plated body ball valve
- 1/4 " - 4" Messing vernickelt Kugelhahn Körper
- 1/4 " - 4" Níquel Latón válvula de bola de cuerpo chapado
- 1/4 " - 4" Laiton nickelé vanne à boisseau sphérique du corps plaqué

**Brass Ball Valve, Yellow
Locking Lever. F x F
BSPT**



Description

Nickel plated brass ball valve. Full bore screwed BSPT female x female with yellow PVC coated lever with locking device. 1/4" - 1" PN40, 1 1/4" - 2" PN25, 2 1/2" - 4" PN16, Temperature Range -20°C to 110°C.



Beschreibung

Messing vernickelt Kugelhahn . Voller Durchgang BSPT- weiblichen x Frau mit gelben PVC-beschichteten Hebel mit Arretierung . 1/4 " - 1" PN40 , 1 1/4 " - 2" PN25 , 2 1/2 " - 4" PN16, Temperaturbereich -20 ° C bis 110 ° C .



Descripción

Níquelado válvula de bola de latón . Paso total atornilla BSPT hembra x hembra con amarillo palanca recubierta de PVC con dispositivo de bloqueo . 1/4 " - 1 " PN40 , 4.11 " - 2 " PN25 , 2 1/2 " - 4 " PN16 , Rango de temperatura -20°C a 110°C .



Descripción

Nickelé vanne à bille en laiton . Passage intégral vissé BSPT femelle x femelle avec PVC jaune levier revêtu de dispositif de verrouillage . 1/4 " - 1" PN40 , 1 1/4 " - 2 " PN25 , 2 1/2 " - 4 " PN16 , Plage de température -20°C à 110°C .

- **Full Bore BSPT Female x Female**
- **Lever Handle**

Description

Brass nickel plated, full bore ball valve. Screwed BSPT female with PTFE seats, NBR/Viton stem O rings, anti-blow out stem. Yellow PVC coated Steel lockable lever.

Typical Applications For Isolation of industrial and domestic process. Heating, Hot water, Cold water, oil and air pipe systems

-  Brass Ball Valve with Locking Lever Handle - BSPT
-  Messingkugelventil mit Feststellhebelgriff- BSPTAprobado Latón
-  Válvula de bola de latón con Bloqueo de manija de palanca - Laiton
-  Ball Valve avec la poignée de blocage de levier - BSPT

Manual Brass Ball Valve with Locking Lever Handle

Description

Brass Nickel Plated Full Bore Ball Valve - with Locking Device (Padlock not included)

Yellow lockable lever with PVC sleeve.
Screwed BSPT Female
Temperature range Fluids -20°C - +110°C
Pressure 1/4" - 1" 40 Bar
1 1/4" - 2" 25 Bar, 2 1/2" - 4" PN16

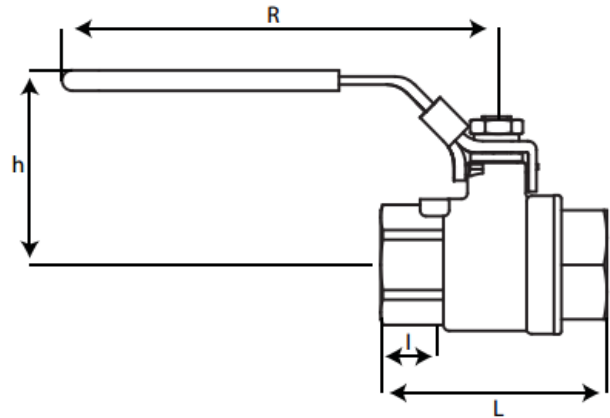

DIMENSIONS						
DN	Size	I	L	h	R	Kg
10	1/4"	14	48.5	45	97	0.1
12	3/8"	16.5	56	48	96	0.01
15	1/2"	16	58.5	51	95	0.2
20	3/4"	16	62	54	95	0.2
25	1"	18	71	66	111	0.4
32	1 1/4"	19	83.5	69	133	0.6
40	1 1/2"	24	101	78	130	1
50	2"	20	104.5	99	200	1.5
65	2 1/2"	33	152.5	125	245	3.8
80	3"	36	170	135	245	5
100	4"	41	205	145	245	8.3

Material List	
Body	Brass
Bonnet	Brass
Ball	Brass
Stem	Brass
Seat	PTFE
Handle	Iron
Nut	Brass
O-Ring	NBR

Pressure / Temperature Ratings

Pressure	1/4" - 1" PN40 1 1/4" - 2" PN25 2 1/2" - 4" PN 16
Temperature	-20°C to 110°C