





SKU: AB4111

-  VOLT Hygienic Pneumatically Actuated Ball Valve
-  VOLT Hygienic Pneumatisch betätigte Kugelhähne
-  Válvula de bola con actuador neumático VOLT Higiene
-  VOLT hygiénique à actionnement pneumatique Ball Valve

Valves[™]
O N L I N E

- ½" - 4" Pneumatically Operated Sanitary Ball Valve
- ½" - 4" pneumatisch gesteuert Sanitärkugelhahn
- ½" - 4" neumática Válvula de bola Sanitaria
- ½" - 4" pilotage pneumatique sanitaire Ball Valve

Plain and Clamp
Ended

Hygienic Pneumatic
Actuated Ball valve



- **No Dead Space in Through Path**
- **Encapsulated Hygienic Seats**
- **All Materials Comply with FDA Requirements**
- **Clamp and OD Weld End Connections**
- **Double Acting and Spring Return**
- **Fully Maintainable**

Description:

VOLT range of pneumatically actuated sanitary ball valves, fulfil a wide variety of on-off hygienic applications. Available in spring return and double acting and Plain weld OD and Tri Clamp ends which exhibit high flow rates by virtue of the true tube full port which offers no dead space in the through path. All actuators are design to the latest ISO/Namur standards and are ATEX approved. End of Stroke adjustment ($\pm 5^\circ$) is fitted as standard.

The ball valves are of 3 piece design and fitted with encapsulated FDA approved PTFE seats and suitable for CIP cleaning.

The actuators fit directly onto the valves so no mounting kit is required, thus making the package more compact and cost effective.



Description

Pneumatically operated ultra pure ball valve, having cavity filled hygienic seats in sizes ranging from ½" to 4". The valve is a three piece design that can be maintained. We offer OD weld or Tri-clamp end connections with a choice of Spring Closed or Double Acting Actuator. Pressures up to 1000 PSI and temperature Range -20°C to 180°C.



Beschreibung

Pneumatisch betätigt Reinstwasser Kugelhahn, mit Hohlraum gefüllt hygienischen Sitze in Größen von ½ "bis 4" . Das Ventil ist ein dreiteiliges Design, das erhalten werden kann. Wir bieten OD Schweiß- oder Tri -Clamp- End-Verbindungen mit einer Auswahl von Frühling Geschlossen oder doppelwirkender Antrieb . Drücke bis zu 1000 PSI und Temperaturbereich -20 ° C bis 180 ° C .



Descripción

De accionamiento neumático válvula de bola de ultra pura , teniendo la cavidad llena de asientos de higiene en tamaños que van desde ½ "a 4" . La válvula es un diseño de tres piezas que se puede mantener . Ofrecemos soldadura DO o Tri -clamp conexiones finales con una selección de Primavera Cerrado o actuación doble actuador . presiones hasta 1000 PSI y rango de temperatura -20°C a 180°C .







Description

Vanne à commande pneumatique de balle ultra pure, ayant cavité remplie sièges d'hygiène dans des tailles allant de ½" à 4" . La vanne est une conception à trois pièces qui peut être maintenue . Nous offrons soudure OD ou Tri-clamp raccords d'extrémité avec un choix de printemps Fermé ou actionneur double effet . pressions jusqu'à 1000 PSI et Plage de température -20°C à 180°C .

Flush and Drain (CIP/SIP) Capability

Boses are provided in the end caps for both flush and drain capability in applications where material can become trapped in the body cavity.

-  VOLT Hygienic Pneumatically Actuated Ball Valve
-  VOLT Hygienic Pneumatisch betätigte Kugelhähne
-  Válvula de bola con actuador neumático VOLT Higiene
-  VOLT hygiénique à actionnement pneumatique Ball Valve

Plain OD Weld Ended Pneumatic Ball Valve

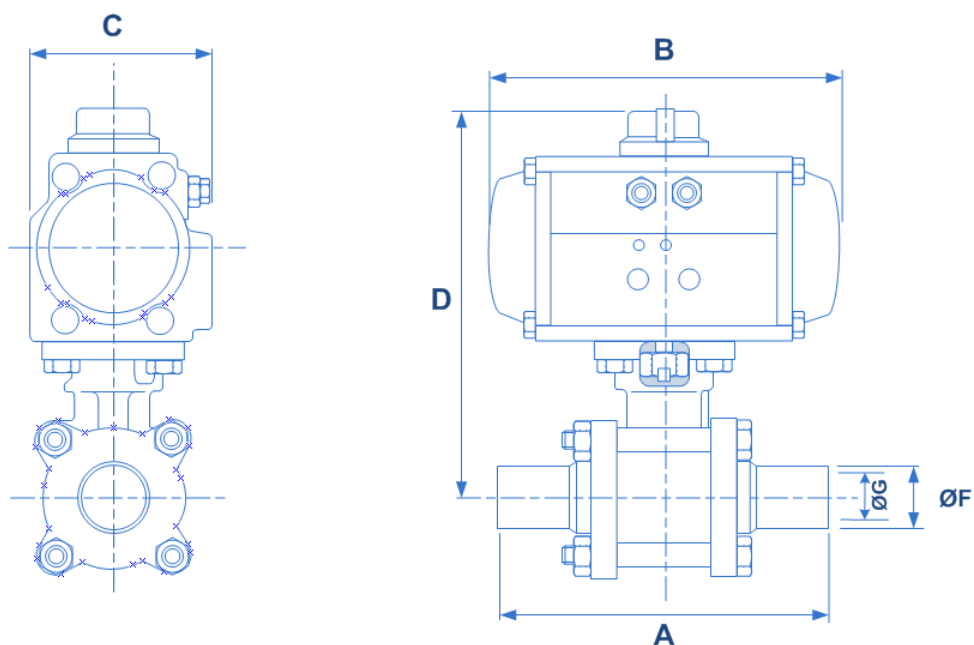

Dimensions							
Valve	Double Acting	A	B	C	D	ØF	ØG
1/2" (15mm)	HP50D	140	144	72	232	9.4	12.7
3/4" (20mm)	HP50D	146	144	72	232	15.8	19
1" (25mm)	HP63D	158	163	85	272	22.2	25.4
1 1/2" (40mm)	HP66D	190	202	85	339	34.9	38.1
2" (50mm)	HP75D	216	210	96	351	47.5	50.8
2 1/2" (65mm)	HP88D	248	247	108	448	60.3	63.5
3" (80mm)	HP100D	267	268	123	549	73	76.2
4" (100mm)	HP100D	317	268	123	549	97.4	102





Dimensions							
Valve	Spring Return	A	B	C	D	ØF	ØG
1/2" (15mm)	HP63S	140	163	85	246	9.4	12.7
3/4" (20mm)	HP63S	146	163	85	246	15.8	19
1" (25mm)	HP66S	158	202	85	272	22.2	25.4
1 1/2" (40mm)	HP88S	190	247	108	351	34.9	38.1
2" (50mm)	HP100S	216	268	123	363	47.5	50.8
2 1/2" (65mm)	HP115S	248	316	141	466	60.3	63.5
3" (80mm)	HP125S	267	347	151	549	73	76.2
4" (100mm)	HP125S	317	347	151	549	97.4	102

Can be combined with



Switch box and Solenoids

Weight		
Size	SR	DA
1/2"	2.5	2.2
3/4"	2.5	2.2
1"	3.8	3.6
1 1/2"	7.6	7.5
2"	10.7	10.2
2 1/2"	19	18
3"	24	21.5
4"	25	24

-  VOLT Hygienic Pneumatically Actuated Ball Valve
-  VOLT Hygienic Pneumatisch betätigte Kugelhähne
-  Válvula de bola con actuador neumático VOLT Higiene
-  VOLT hygiénique à actionnement pneumatique Ball Valve

Tri - Clamp Ended Pneumatic Ball Valve

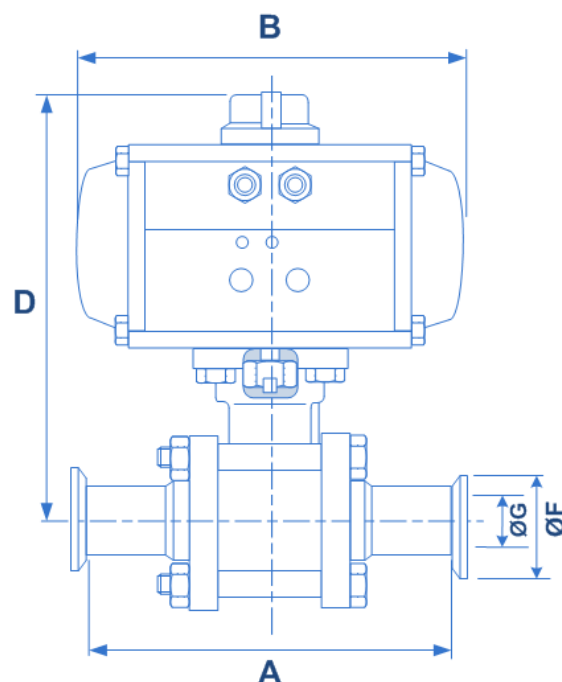
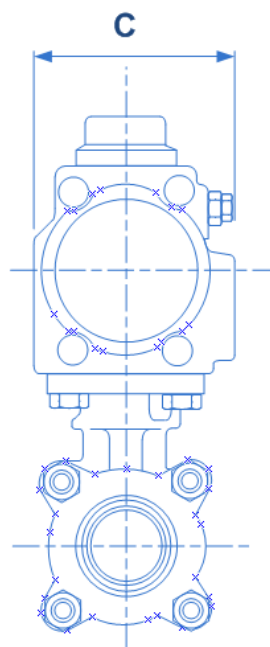

		Dimensions					
Valve	Double Acting	A	B	C	D	ØF	ØG
1/2" (15mm)	HP50D	89.1	144	72	232	20	12.7
3/4" (20mm)	HP50D	102	144	72	232	23	19.1
1" (25mm)	HP50D	115	163	85	272	25	25.4
1 1/2" (40mm)	HP63D	140	202	85	339	25	38.1
2" (50mm)	HP63D	159	210	96	351	25	50.8
2 1/2" (65mm)	HP75D	174	247	108	448	25	63.5
3" (80mm)	HP88D	193	268	123	549	25	76.2
4" (100mm)	HP88D	226	268	123	549	25	102

		Dimensions					
Valve	Spring Return	A	B	C	D	ØF	ØG
1/2" (15mm)	HP50S	89.1	163	85	246	20	12.7
3/4" (20mm)	HP63S	102	163	85	246	23	19.1
1" (25mm)	HP63S	115	202	85	272	25	25.4
1 1/2" (40mm)	HP66S	140	247	108	351	25	38.1
2" (50mm)	HP66S	159	268	123	363	25	50.8
2 1/2" (65mm)	HP88S	174	316	141	466	25	63.5
3" (80mm)	HP100S	193	347	151	549	25	76.2
4" (100mm)	HP100S	226	347	151	549	25	102

Can be combined with







Modulating Positioner



Weight

Size	SR	DA
1/2"	2.5	2.2
3/4"	2.5	2.2
1"	3.8	3.6
1 1/2"	7.6	7.5
2"	10.7	10.2
2 1/2"	19	18
3"	24	21.5
4"	25	24

-  VOLT Hygienic Pneumatically Actuated Ball Valve
-  VOLT Hygienic Pneumatisch betätigte Kugelhähne
-  Válvula de bola con actuador neumático VOLT Higiene
-  VOLT hygiénique à actionnement pneumatique Ball Valve

Hygienic Actuated ball valve

Technical - Actuator	
Body material	Hard anodised extruded aluminium alloy
End Caps	Die cast aluminium epoxy coated
Spring	High tensile steel
Indicator	Open/Closed
Pinion shaft	Alloy steel nickle plated
Pinion Guides	Self Lubricating Polypropylene + GF
Piston seals	NBR steel
Specification	
Pressure range	10 Bar
Double acting	2.5 Bar - 8 Bar
Single acting - Open or Close	2.5 Bar - 8 Bar
Temperature range	minus 20°C - 80°C
Movement	90 Degree adjustable -5-+5 Degree
Lubrication	All moving parts are lubricated
Cycle Life	1,000,000 operations
Approvals	ATEX, CE, PED

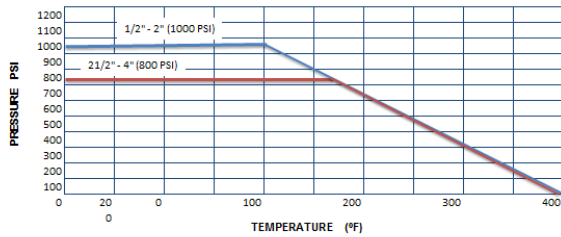

Valves Technical and Parts List	
Part Name	Material
Body	CF8M
End Cap	CF8M
Ball	SUS316
Stem	SUS316
Stem Nut	SUS304
Thrust Washer	SUS304
Handle	SUS304
Seat	PTFE
Gland Ring	SUS304
Stem Packing	PTFE
Belleville washer	SUS304
Nut	SUS304
Specification	
Pressure range	1/2" to 2" 1000 PSI
Size	2 1/2" to 4" 800 PSI
Temperature range	minus 20° to + 180° (see graph)
Movement	90 deg turn
Cycle life	1,000,000 operations



Switch box and Solenoids fitted to complete the perfect valve



Three way sanitary diverting ball valves



Pneumatic sanitary butterfly valves, complete actuated hygienic essentials