

SKU: GV5001

- 🇬🇧 Heavy Duty Brass Gate Valve PN25 Rated
- 🇩🇪 Heavy Duty Messing Schieber PN25 bewertet
- 🇪🇸 Deber de latón pesado puerta de la válvula PN25 Calificación
- 🇫🇷 Heavy Duty Laiton Vanne PN25 Évalué

Valves[™]
ONLINE

- 1/4" - 4" Brass BSPT Gate Valve
- 1/4" - 4" Messing BSPT Absperrschieber
- 1/4" - 4" Válvula de compuerta de latón BSPT
- 1/4" - 4" Brass BSPT Vanne

Heavy Duty Brass Gate Valve - PN25



- WRAS Approved
- Cast Body
- Non Rising Stem
- Easy to Operate

Description:

A Heavy Duty Brass Hand Wheel Operated Gate Valve Screwed BSPT.
Brass Body & Bonnet, Cast Hand wheel.
PN25 Rated,
Temperature Range -20°C to 120°C



Description

VOLT Brass gate valve classed as Heavy Pattern. Hand wheel operated, with screwed bonnet and non rising stem. Supplied in sizes from 1/4" up to 4".
Full Bore
Maximum pressure 25 Bar
Temperature 20°C to 120°C
Screwed BSPT
Holds WRAS Approval for drinking water.



Beschreibung

VOLT Messing Absperrschieber als Schwer Muster eingestuft . Handrad betrieben , mit Kopfstück und nicht steigender Spindel. Lieferung in den Größen von 1/4 " bis 4" Vollbohrung
Maximaler Druck 25 bar
Temperatur 20 ° C bis 120 ° C
BSPT-
Hält WRAS Zulassung für Trinkwasser.







Description

Válvula de compuerta de latón VOLT clasificado como pesado Patrón. Volante operado , con el capo atornillado y el vástago no ascendente. Se suministra en tamaños desde 1/4 " hasta 4" .
Bore completa
Presión máxima de 25 bar
Temperatura 20°C a 120°C
Screwed BSPT
Sostiene WRAS aprobación para el agua potable .



Description

VOLT laiton vanne classé comme modèle lourd . Volant à main actionné,
avec Screwed capot et tige non montante . Livré dans les tailles de 1/4 " jusqu'à 4" .
Full Bore
Pression maximale de 25 bar
Température 20 ° C à 120 ° C
Taraudé BSPT
Dit WRAS Approbation pour l'eau potable .

-  Heavy Duty Brass Gate Valve PN25 Rated
-  Heavy Duty Messing Schieber PN25 bewertet
-  Deber de latón pesado puerta de la válvula PN25 Calificación
-  Heavy Duty Laiton Vanne PN25 Évalué

Heavy Duty Brass Gate Valve BSPT

- WRAS Approved
- Cast Body
- Non Rising Stem
- Easy to Operate

Material	
Body	Brass
Wedge	Brass
Stem	Aluminium Bronze
Bonnet	Brass
Gasket	PTFE
Packing	Epoxy Laminate
Hand wheel	Red Die Cast
Gland Nut	Brass
Lock Nut	Brass

Pressure / Temperature Ratings	
Max Pressure	25 Bar
Temperature	-20°C to 120°C

Dimensions							
Size	DN	L	H	L1	B	Od	A
1/2"	15	54	76	12.5	12.7	7	56
3/4"	20	59	80	12.7	19	8	56
1"	25	66	98	14.5	25	9.5	71
1 1/4"	32	74	112	16.8	32	11	71
1 1/2"	40	75	120	16.8	39	11	71
2"	50	86	146	21.1	50	12.5	81
2 1/2"	65	99	192	23.2	63.5	14	100
3"	80	115	218	26.3	76	15.5	108
4"	100	134	264	32.2	100	17.5	126

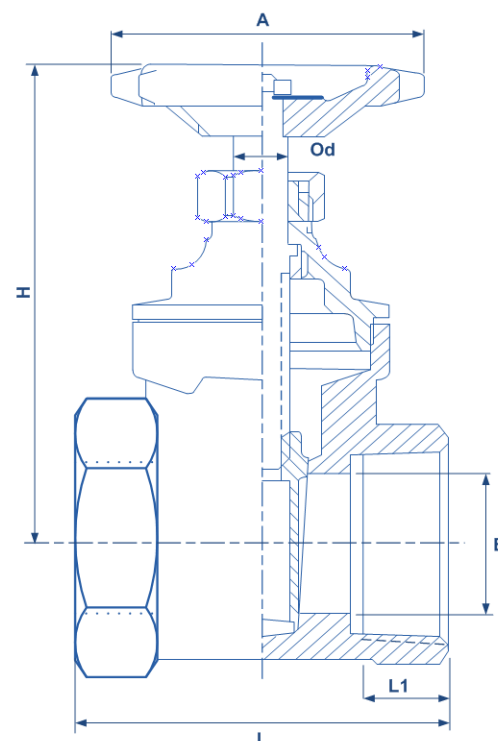

Weight	
Size	Kg
1/2"	0.33
3/4"	0.43
1"	0.66
1 1/4"	0.94
1 1/2"	1.28
2"	2.2
2 1/2"	3.64
3"	5.6
4"	9.37