





SKU: BV5088

-  VOLT PN16 Flanged Manual Ball Valve in Stainless Steel
-  VOLT PN16 Flansch Anleitung Kugelhahn in Edelstahl Steel
-  VOLT Válvula manual de bola con bridas PN16 en acero inoxidable
-  VOLT PN16 à brides vanne à boisseau sphérique manuel en acier inoxydable

Valves[™]
O N L I N E

- 1/2" - 4" Stainless steel PN16 flanged ball valve
- 1/2" - 4" Edelstahl PN16 Flansch Kugelhahn
- 1/2" - 4" PN16 válvula de bola con bridas de acero inoxidable
- 1/2" - 4" Acier inoxydable PN16 vanne à boisseau sphérique à bride

Flanged PN16 Manual Ball Valve

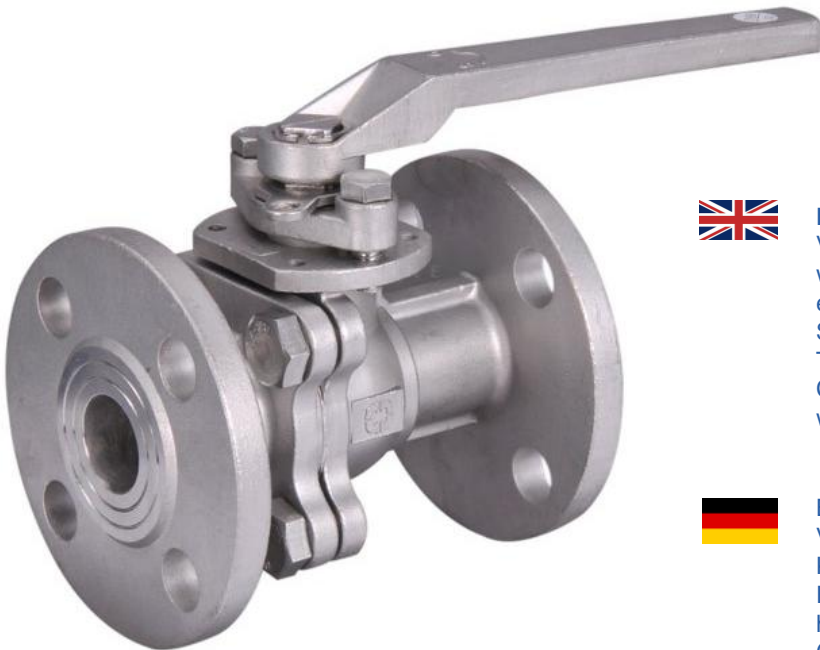

- PN16 Flanged
- Full Bore
- DIN 3202 F-4 face to face
- 180° C
- Stainless Steel
- PTFE Seats and Seals

DESCRIPTION

A good quality, cost effective general purpose flanged ball valve suitable for most Liquid and Gaseous duties. 2-Pce Full Bore flanged PN16 ball valve. ASTM A351 CF8M 316 Stainless Steel construction, 316 Trim. PTFE Seats and Seals. Adjustable gland. Lever operated. The valve is suitable for manual on off operation and offers a non direct mount Fire-safe design (not certified). 1/2" - 2" PN40 pressure rated. 2 1/2" - 4" PN16 pressure rated. -20°C + 180° C Temperature rated. CE marked (sizes 1 1/4" upward) in accordance with the PED 97/23. DIN 3202 F-4 Face to Face dimension. Full material Test Certificates available. Available size range: 1/2" - 6"



Description

Volt 2 piece PN16 flanged manual ball valve with full port in stainless steel. This valve offers economy with high performance. Size 1/2" to 4" supplied with Lever Handle Temperature Range -20° C to 180° C. CE marked (sizes 1 1/4" upward) in accordance with the PED 97/23.



Beschreibung

Volt 2 Stück PN16 angeflanscht manuellen Kugelhahn mit vollem Durchgang aus Edelstahl. Dieses Ventil bietet Wirtschaft mit hoher Leistung. Größe 1/2 "bis 4" geliefert mit Hebelgriff Temperaturbereich -20 ° C bis 180 ° C CE-Kennzeichnung (Größen 1 1/4 " nach oben) in Übereinstimmung mit der PED 97/23 .







Descripción

2 voltios pieza PN 16 bridas de válvula de bola manual con puerto completo en acero inoxidable. Esta válvula ofrece la economía con un alto rendimiento . Tamaño 1/2 "a 4 " suministrado con la manija de palanca Rango de temperatura de -20 ° C a 180 ° C. con marca CE (tamaños 1 1/4 " hacia arriba), de conformidad con la PED 97/23 .



Description

Volt 2 pièce PN16 bridé vanne manuelle à bille avec passage intégral en acier inoxydable . Cette vanne offre l'économie avec la haute performance . Taille 1/2 "à 4" fourni avec poignée à levier Plage de température -20 ° C à 180 ° C Marqués CE (tailles 1 1/4 " vers le haut) , conformément à la PED 97/23 .

-  VOLT PN16 Flanged Manual Ball Valve in Stainless Steel
-  VOLT PN16 Flansch Anleitung Kugelhahn in Edelstahl Steel
-  VOLT Válvula manual de bola con bridas PN16 en acero inoxidable
-  VOLT PN16 à brides vanne à boisseau sphérique manuel en acier inoxydable

Flanged PN16 Stainless steel Ball Valve

- PN16 Flanged
- Full Bore
- Lockable Handle
- 180° C
- Stainless Steel

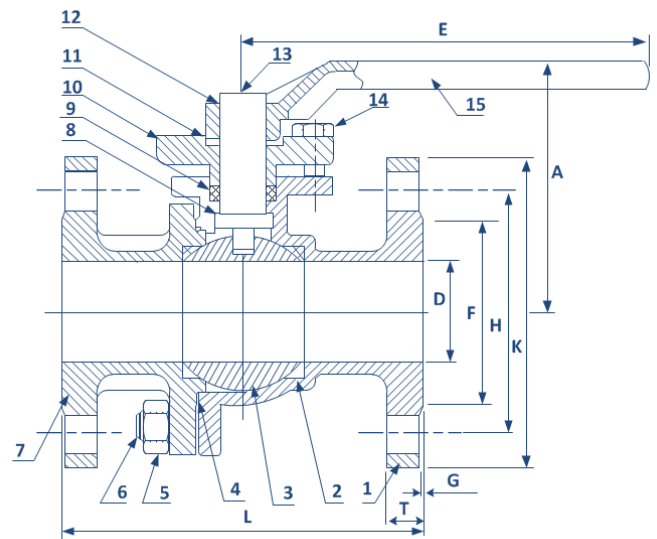

A good quality, cost effective general purpose flanged ball valve suitable for most Liquid and Gaseous duties. DIN 3202 F-4 Face to Face dimension (DIN 3202 F-5 on 6" size). Full material Test Certificates available.

MATERIALS			
ITEM	DESCRIPTION	MATERIAL	NO.
1	BODY	CF8M	1
2	BALL SEAT	RPTFE	1
3	BALL	CF8M	1
4	BODY SEAT	PTFE	1
5	NUT	304	4 or 8
6	BOLT	304	4 or 8
7	CAP	CF8M	1
8	STEM SEAL	PTFE	1
9	STEM PACKING	PTFE	1
10	GLAND	CF8M	1
11	STOPPER	304	1
12	SNAP RING	304	2
13	STEM	304/316	1
14	BOLT	304	2
15	HANDLE	CF8	1

Dimensions											
	DN	D	L	A	E	F	G	H	K	T	Weight Kg
PN16-40	15	1/2"	115	75	130	35	2	TBA	TBA	11	1.9
	20	3/4"	120	75	130	43	2	TBA	TBA	11	2.4
	25	1"	125	85	160	51	2	TBA	TBA	12	3.1
	32	1 1/4"	130	90	160	64	2	TBA	TBA	13	4.4
	40	1 1/2"	140	125	200	73	2	TBA	TBA	15	5.8
	50	2"	150	130	200	92	2	TBA	TBA	16	7.5
PN16	65	2 1/2"	170	160	325	105	2	TBA	TBA	18	11
	80	3"	180	164	325	127	2	TBA	TBA	19	15.5
	100	4"	190	178		157	2	TBA	TBA	24	20